

Totaline® Fan and Bypass Humidifiers

P110-LFP1518, P110-LBP2417, P110-SBP2412



P110-LBP2417



P110-SBP2412



P110-LFP1518



As warm air passes through the humidifier pad and water flows through it, natural evaporation takes place. This creates comforting humidity which is distributed throughout the house by your forced air heating system.

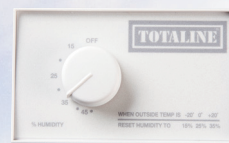

4363

Optimal generation of comforting moisture.

Working together, Totaline's water solenoid valve, water metering orifice, water distribution tray and aluminum humidifier pad efficiently generate maximum levels of comforting moisture.

Simple, Infrequent Maintenance.

Totaline humidifiers are designed for easy serviceability. In most instances it takes less than ½ hour since maintenance (including changing the humidifier pad) is performed once a season. Unlike portables, there are no reservoirs which need to be frequently cleaned and refilled.

Long Lasting high quality components.

With proper maintenance, your humidifier will last for many years. That's because it's designed with durable UV and corrosion resistant plastic. This plastic resists deterioration even when exposed to Ultraviolet light sources common in many systems today.

Three humidity control options.

Choose between 3 separate control options; the humidistat, the HumidiTrac and the Thermidistat control. Each option provides precise control of humidity levels in your home.

Quiet Operation.

Nearly silent operation is the result of Totaline Humidifier's precision engineered fan and motor combination in the large fan powered unit. In all Totaline units, air is quietly drawn through the humidifier pad which efficiently turns water into water vapor to humidify your home.

Warranty

Electrical components are covered by a **five-year limited warranty** and the entire unit is backed by a **one-year limited warranty**.



Totaline® Fan and Bypass Humidifiers

P110-LFP1518, P110-LBP2417, P110-SBP2412

Physical Data:

HUMIDIFIER	Model P110-LFP1518	Model P110-LBP2417	Model P110-SBP2412
Gallons Per Day**	18 GPD**	17 GPD**	12 GPD**
Water Feed Rate	6 gal/hr	3 gal/hr	3 gal/hr
TYPE			
Airflow	Fan	Bypass	Bypass
Waterflow	Drain Through	Drain Through	Drain Through
GENERAL			
Evaporator Pad Replacement	P110-3545	P110-3545	P110-1045
Evaporator Pad Size H x W x D (in.)	13 x 10 x 1-11/16	13 x 10 x 1-11/16	9-7/8 x 9-5/8 x 1-11/16
Pad Access	Quick Release Cover	Quick Release Cover	Quick Release Cover
Unit Size includes solenoid valve H x W x D (in.)	15-15/16 x 15-7/8 x 10-3/8	15-1/2 x 13-1/8 x 9-1/8	12-3/4 x 12-3/4 x 9-1/8
Weight	15.7 lbs.	8.3 lbs.	7.4 lbs.
Transformer	Class 2, 10VA (Included)	Class 2, 10VA (Included)	Class 2, 10VA (Included)
Water Usage	6 gal/hr	3 gal/hr	3 gal/hr
ELECTRICAL CONTROL			
LOW VOLTAGE TERMINALS			
Volts	24V - 60Hz	24V - 60Hz	24V - 60Hz
Amps. (Max)	0.5	0.5	0.5
VA (Max)	12	12	12
Watts	6	6	6
HIGH VOLTAGE CORD			
Volts	115V - 1ph - 60Hz	N/A	N/A
Amps. (Max)	10 amp rating	N/A	N/A
CONNECTIONS			
Water Inlet	1/4 inch copper tubing	1/4 inch copper tubing	1/4 inch copper tubing
Water Drain	1/2 inch I.D. plastic hose	1/2 inch I.D. plastic hose	1/2 inch I.D. plastic hose
Bypass Opening	N/A	6 inch round elbow or straight	6 inch round elbow or straight
Duct Opening W x H (in.)	14-3/4 x 14-5/16	9-7/8 x 12-5/8	9-1/2 x 9-1/2
STANDARD EQUIPMENT			
Water Valve	Solenoid, 24 VAC	Solenoid, 24 VAC	Solenoid, 24 VAC
Motor* Thermal Protection	120 VAC	N/A	N/A
Relay DPDT	24 VAC	N/A	N/A
Humidistat	24 V	24 V	24 V
Saddle Valve	Standard	Standard	Standard
Damper	N/A	Built-in, 6 inch round	Built-in, 6 inch round
Template	Installation Template Included	Installation Template Included	Installation Template Included
ACCESSORIES			
HumidiTrac Automatic Control	P110-0056	P110-0056	P110-0056
Current Sensing Relay	P110-0050	P110-0050	P110-0050

* 14mHP (0.014H = 1/70 HP)

** Based on 120°F plenum temperature, 71.5°F water temperature

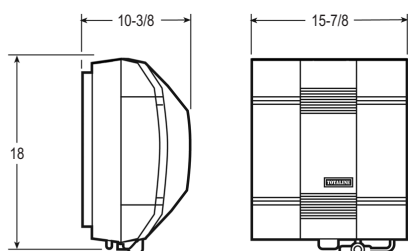

Model: P110-LFP1518

Duct Cut Out Size: 14-3/4"W x 14-5/16"H

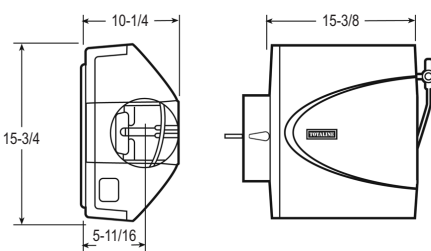

Model: P110-LBP2417

Duct Cut Out Size: 9-7/8"W x 12-5/8"H

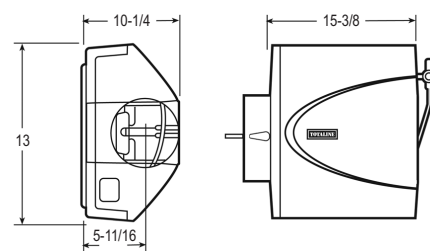

Model: P110-SBP2412

Duct Cut Out Size: 9-1/2"W x 9-1/2"H

