

INSTRUCTIONS



Carrier

A United Technologies Company

Page 1 of 6



99TA520029 (for RCD use only)

Instruction Sheet Number: **99TA520029**

Description: Motor Mount Kit

Author: R.C.

Date: October 1, 2007

Part Number: 50HJ660009

SAFETY CONSIDERATIONS

Improper installation, adjustment, alteration, service, maintenance or use can cause explosion, fire, electrical shock, or other conditions which may cause death, personal injury, or property damage. Consult a qualified installer, service agency, or your distributor or branch for information or assistance. The qualified installer or agency must use factory—authorized kits or accessories when modifying this product.

DISCRIPTION AND USAGE

This instruction manual covers installation of the indoor fan blower motor mounting kit to replace mounting plate's 50HJ402383 and/or 50HJ502179 and/or 50DK504885. Please read all instructions before starting.

This kit consists of:

ITEM	DESCRIPTION	PART NUMBER	QTY
1	MOTOR MOUNT (18.42 X 8.86 X 2" DEEP)	50HJ542487	1
2	BRACKET, MOTOR (1" X 3")	50HJ542490	2
3	BRACKET, SUPPORT (9.65" X 1.89")	50HJ542489	2
4	BRACKET,SPRT(ANGLE 1.25 X 1.25 X 17.72)	50HJ542491	1
5	INSTALLATION INSTRUCTIONS	99TA520029	1
6	BOLT-5/16-18 X 1-3/4" CARRIAGE	AH20AB204	4
7	BOLT-5/16-18 X 1" CARRIAGE	AH19AB198	4
8	NUT-5/16-18	AT39AB201	12
9	WASHERS-5/16" LOCK	AU11AS201	12
10	WASHERS-5/16" FLAT	AU02AB202	12
11	WASHERS-5/16" STAR	AU27AS201	2
12	BOLT-5/16-18 X 12" CARRIAGE	AH19AB552	2
13	SCREW 10-16 X 1/2 LG (THREAD FORMING)	AL76AU216	6

INSTALLATION

1. Remove existing motor mounting plates (50DK504885 and 50HJ502179) from blower housing as shown in Figure 1 before installing new motor mounting hardware. Discard these parts.



Figure 1 - Existing motor mount hardware.

2. Use the long angle support bracket (item #4) as a template to determine the $\frac{1}{4}$ " clearance hole locations to mount it inside the side plate flanges on the blower assembly with two Screws (item# 13) as show below.



Figure 2

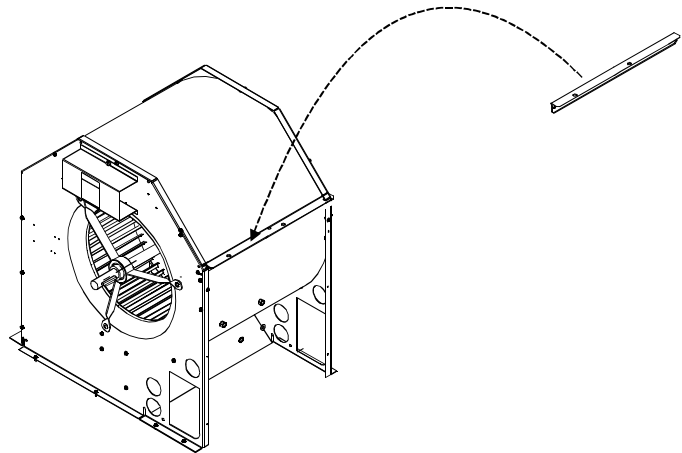

Figure 3

3. Assemble 12" Carriage Bolts (item #12) to Motor Mount (item #1) using two Motor Bracket (item #2) and four screws (item #13). Thread two Nuts (item #8) about half way down the Carriage Bolts. The sub assembled parts should look like figure 4.

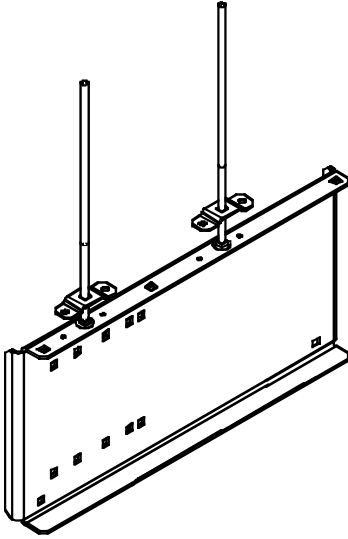

Figure 4

4. Next attach Motor Mount Assemble to Blower with two Support Bracket's (item #3) and four 1-3/4" Carriage Bolts, four Flat Washer , four Lock Washer and four Nuts (items #6, 8, 9 and 10) to Motor Mount (item #1). With 12" Carriage Bolt going thru the Support Bracket already attached to the Blower and thread two more Nuts (item #8) on the 12" Carriage Bolts.

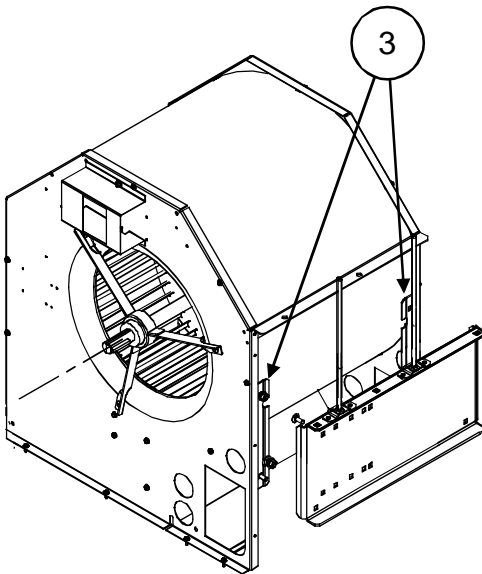

Figure 5

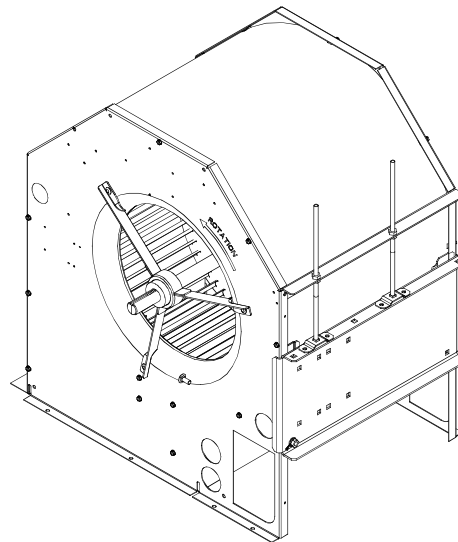

Figure 6

5. Install Motor to Motor Mount with four 1" Carriage Bolts, four Flat Washer, four Lock Washer, one star washer and four Nuts (items #7, 8, 9 and 10). The one star washer should be placed next to the painted surface of the motor base so that the star washer cuts into the paint and provides a ground path for the motor.

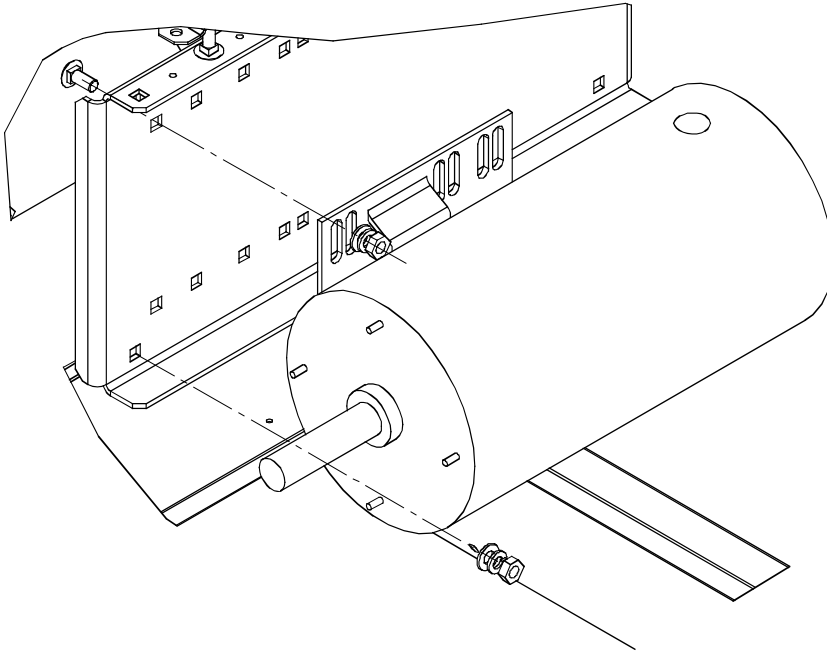

Figure 7

6. Install belt and adjust belt tension by turning four nuts on both motor plate adjusting bolts so that motor plate remains horizontal to fan deck within 1/8 inch from front to back. Adjust belt tension so that 5 lbs of force will cause a deflection of the belt at mid span of 1/4 inch. While holding this tension on the belt tighten the four motor mounting plate adjustment bolts. See Figure 8 and 9.



Figure 8 – Belt Tension Adjustment

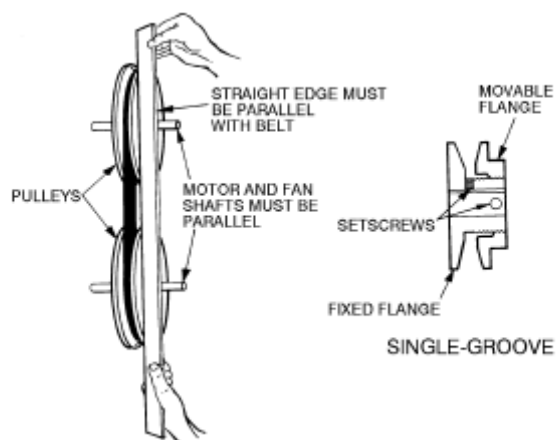

Figure 9 – Belt and Sheave Alignment

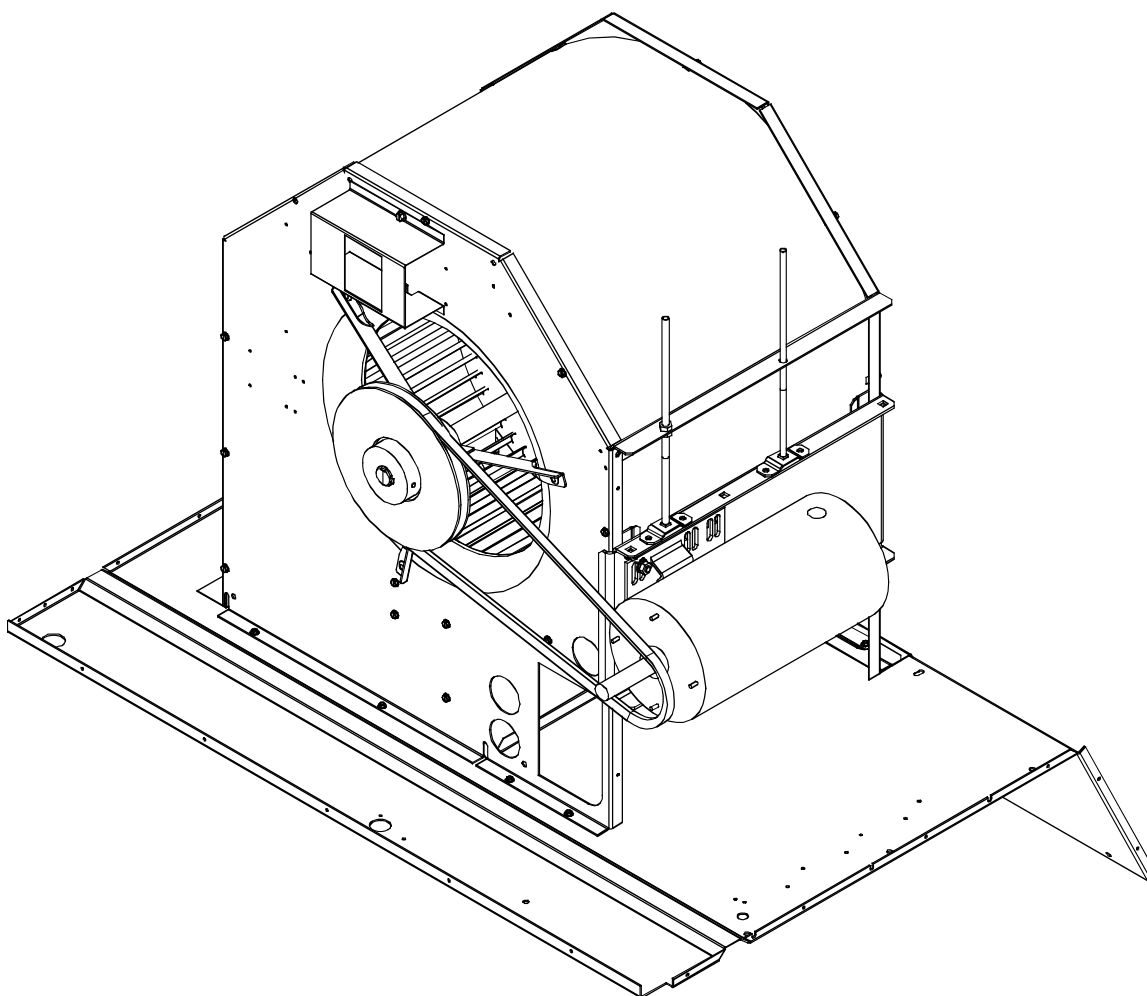

Figure 10