



The Legacy Companies

3355 Enterprise Avenue, Suite 160, Fort Lauderdale, FL 33331

Sales: (954) 202-7419 • Sales@TheLegacyCompanies.com

Tech Service: (877) 368-2797 • Service@MaxxHelp.com

Project Name: _____

Location: _____

Item #: _____ Qty: _____

Model: _____

www.MaxximumFoodService.com

250lb SELF CONTAINED ICE MAKER (w/ Integrated Ice Bin)

Model: ☐ MIM250

International Model: Add -50 (220V/50Hz/1Ph)
or -60 (220V/60Hz/1Ph)



Top View



Bottom



Slanted Cube

Inches: 1.3 x 1.125 x 1
mm: 33 x 29 x 25.4

Self contained ice maker. For freestanding or built in, undercounter applications. Can produce up to 260 pounds of ice per day (under the right conditions). Includes a self-contained 75 pound storage bin. Stainless steel construction provides durability to a unit that is low-maintenance and easy to clean. Front breathing design. Vertical evaporator and proven ice making technology assures years of reliable ice production.

ICE PRODUCTION

Air Temp 70°F (21°C) Water Temp 50°F (10°C)

Daily Ice Production: 260 lbs (118kg)

Air Temp 90°F (32°C) Water Temp 70°F (21°C)

Daily Ice Production: 210 lbs (95kg)

Storage Bin holds 75lbs of ice with automatic overflow prevention
Gravity Drain is required.

OPERATING REQUIREMENTS

Ambient Temp Range 50° to 99°F (10° to 37°C)

Water Temp Range 40° to 90°F (4° to 32°C)

Water Usage 100lbs (45.4kg) of Ice 13.3 Gallons (50L)

Water Supply Line Connection 3/8" FPT

Water Pressure Range

Min PSI 15 Max PSI 80 (above 80 requires a regulator)

Min Bar 1.0 Max Bar 5.5

Energy Consumption kWh/100 lb (45.4 kg) 90°F(32°C)/70°F(21°C)
9.3 kWh/100 lb of ice made

FEATURES and CONSTRUCTION

- Exterior Material: Stainless Steel with Black Trim
 - Air Cooled Compressor
 - Programmable, solid state, digital electronic control system.
 - Built-In Self Cleaning Mode
 - Includes Scoop
 - Includes Tubing for Supply and Drain Lines
 - Includes NEMA 5-15 cord set for simple installation
- * Water Filter Recommended

REFRIGERANT

- CFC & HCFC free R-404A

ELECTRIC

120V/60Hz/1 Ph (NEMA 5-15P)

(220V/50-60Hz/1ph available as an option)



NEMA 5-15P

Maxx Ice WARRANTY (USA / CANADA)

Three (3) years parts

Three (3) years on-site labor

Five (5) years compressor (part only)

Administered by The Legacy Companies, 877.368.2797



Intertek
Certified to
ANSI-NSF 7



Intertek
Certified to
ANSI UL 471



Due to periodic changes in designs, methods, procedures, policies and regulations, the specifications contained in this sheet are subject to change without notice. While we exercise good faith efforts to provide information that is accurate, we are not responsible for errors or omissions in information provided or conclusions reached as a result of using the specifications.

By using the information provided, the user assumes all risks in connection with such use.

The built in performance enhancing functions ensure that given proper attention and preventative maintenance, each Maxx Product will deliver years of trouble free, reliable, low maintenance, efficient operation.

8/30/2016W



The Legacy Companies

3355 Enterprise Avenue, Suite 160, Fort Lauderdale, FL 33331

Sales: (954) 202-7419 • Sales@TheLegacyCompanies.com

Tech Service: (877) 368-2797 • Service@MaxxHelp.com

Project Name: _____

Location: _____

Item #: _____ Qty: _____

Model: _____

www.MaxximumFoodService.com

250lb SELF CONTAINED ICE MAKER (w/ Integrated Ice Bin)

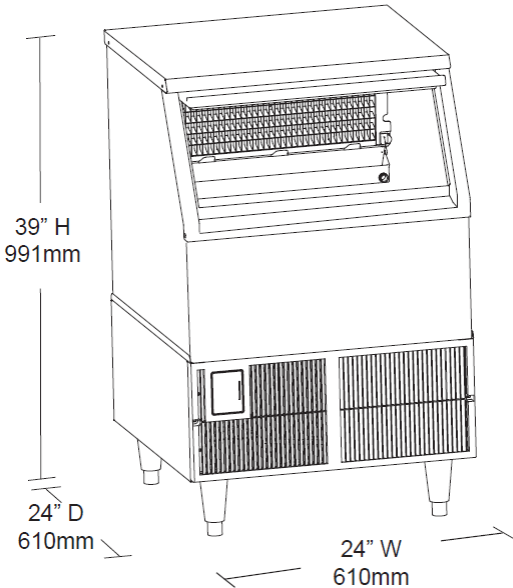

Top View

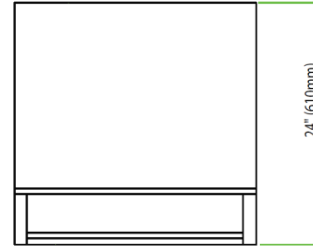

Front View

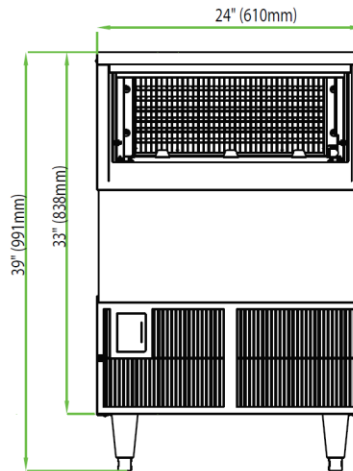

Side View

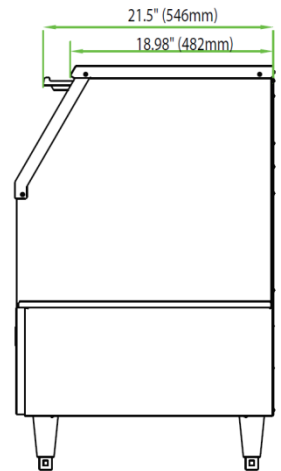

Back View

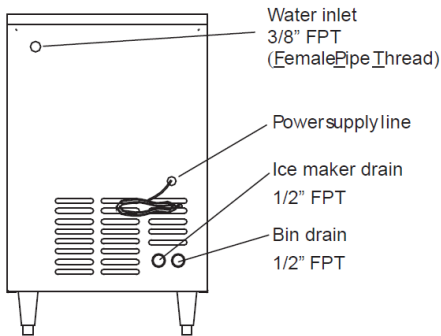

	MIM250
In: External Dimensions W x D x H	24 x 24 x 39
mm: External Dimensions W x D x H	610 x 610 x 991
Electrical Amp Draw	
120V	12 max (normal or nominal draw 10.4 amps)
220V	6.9 max (normal or nominal draw 5.3 amps)
Unit Weight	144 lb / 65 kg
Shipping Weight	160 lb / 72.5 kg

Due to periodic changes in designs, methods, procedures, policies and regulations, the specifications contained in this sheet are subject to change without notice.

While we exercise good faith efforts to provide information that is accurate, we are not responsible for errors or omissions in information provided or conclusions reached as a result of using the specifications. By using the information provided, the user assumes all risks in connection with such use.