

A

| | |
|-----|----|
| 13 | 标准 |
| 201 | 质控 |
| 22 | 采购 |
| 24 | 出商 |
| 29 | 工 |
| 361 | 工 |
| 43 | 金 |
| 44 | 两 |
| 46 | 器 |
| 47 | 一 |
| 48 | 具 |
| 49 | 制 |
| 50 | 四 |
| 51 | 二 |
| 55 | 制 |
| 58 | 巴 |
| 61 | 西 |
| 62 | 重 |
| 63 | 合 |

| | |
|------------|---|
| 是否属于客户化物料 | |
| 是否使用通用出口内销 | ✓ |

| | |
|----|--------|
| 地点 | 状态 |
| 管一 | 是否需再加工 |
| 管二 | 是否需再加工 |
| 借 | 通用登记 |

| | |
|------|--|
| 物料状态 | |
| 钣金 | |
| 注塑 | |
| 两器 | |
| 管路 | |
| 机件 | |
| 采购 | |
| 注塑 | |
| 喷涂 | |
| 丝印 | |
| 控制 | |
| 预装 | |
| 下料 | |
| 发泡 | |
| 壳管 | |

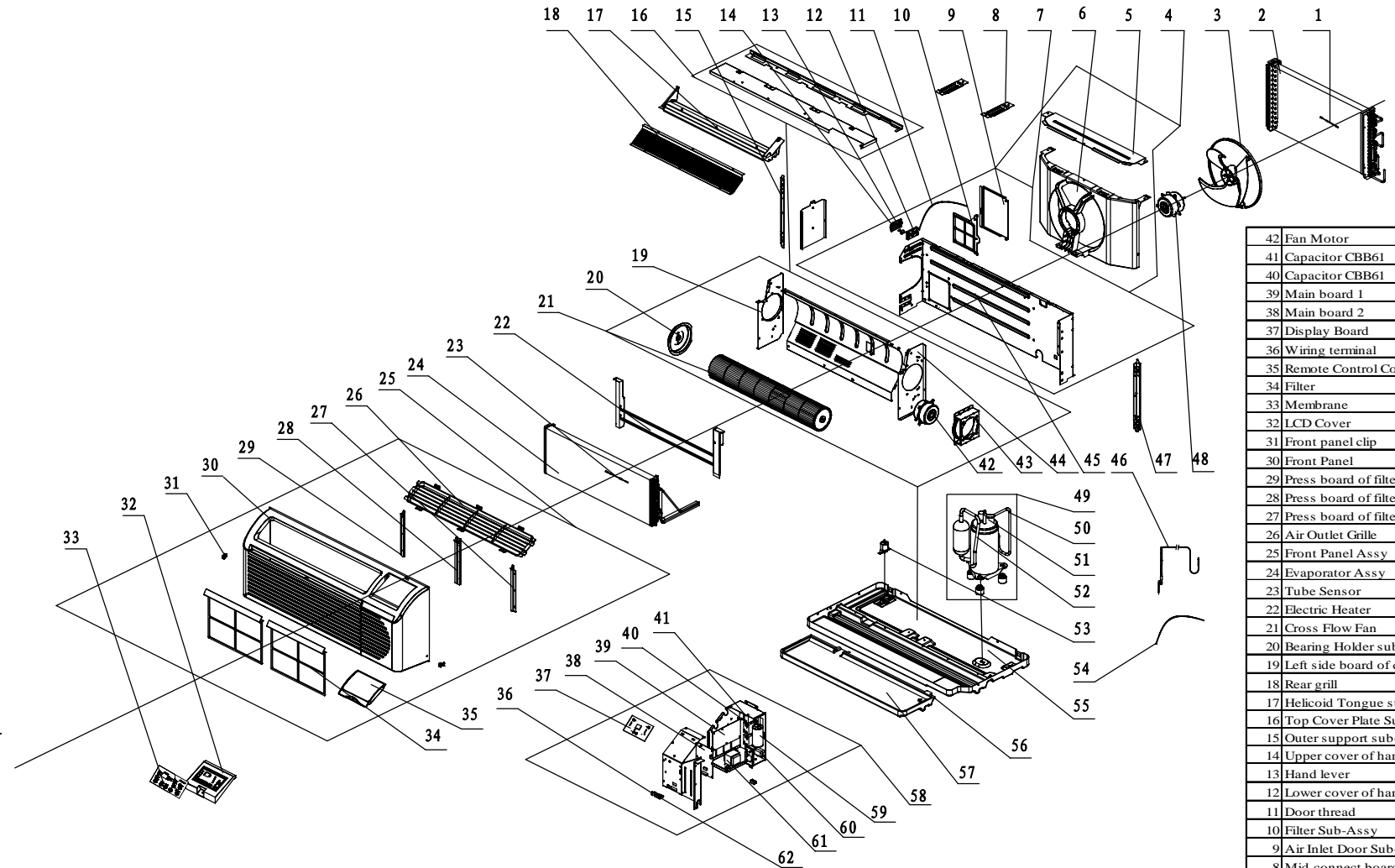

| | | | |
|----|-------------------------------|---------|----------|
| 42 | Fan Motor | 电机 | 内 |
| 41 | Capacitor CBB61 | 电容 | 2uF 450V |
| 40 | Capacitor CBB61 | 电容 | 1uF/500V |
| 39 | Main board 1 | 主板1 | |
| 38 | Main board 2 | 主板2 | |
| 37 | Display Board | 显示板 | |
| 36 | Wiring terminal | 接线端子 | |
| 35 | Remote Control Cover | 遥控盖板 | |
| 34 | Filter | 过滤网 | |
| 33 | Membrane | 面膜 | |
| 32 | LCD Cover | 控制盖板 | |
| 31 | Front panel clip | 面板卡扣 | |
| 30 | Front Panel | 面板 | |
| 29 | Press board of filter 3 | 过滤网压板3 | |
| 28 | Press board of filter 2 | 过滤网压板2 | |
| 27 | Press board of filter 1 | 过滤网压板1 | |
| 26 | Air Outlet Grille | 出风格栅 | |
| 25 | Front Panel Assy | 面板部件 | |
| 24 | Evaporator Assy | 蒸发器部件 | |
| 23 | Tube Sensor | 室内管温感温包 | |
| 22 | Electric Heater | 电加热器 | |
| 21 | Cross Flow Fan | 贯流风叶 | |
| 20 | Bearing Holder sub-assy | 轴承胶座组件 | |
| 19 | Left side board of duct | 风道左边板 | |
| 18 | Rear grill | 护网 | |
| 17 | Helicoid Tongue sub-assy | 蜗舌组件 | |
| 16 | Top Cover Plate Sub-Assy | 顶盖板组件 | |
| 15 | Outer support sub-assy (left) | 外支架组件 | 左 |
| 14 | Upper cover of hand lever | 手柄上盖 | |
| 13 | Hand lever | 手柄 | |
| 12 | Lower cover of hand lever | 手柄下盖 | |
| 11 | Door thread | 风门线 | |
| 10 | Filter Sub-Assy | 过滤网组件 | |
| 9 | Air Inlet Door Sub-assy | 风门组件 | |
| 8 | Mid-connect board | 中间连接板 | |
| 7 | Mid Clapboard Assy | 中隔板部件 | |
| 6 | Diversion Circle | 导流圈 | |
| 5 | Diversion Circle Cover | 导流圈盖板 | |
| 4 | Flow Guide Loop | 导流圈组件 | |
| 3 | Axial Flow Fan | 轴流风叶 | |
| 2 | Condenser Assy | 冷凝器部件 | |
| 1 | Ambient Temperature Sensor | 感温包 | |

| | | | |
|----|--------------------------------|---------|------|
| 62 | Wiring terminal | 接线端子 | (丝印) |
| 61 | Transformer | 电源变压器 | |
| 60 | Terminal Board | 接线板 | (2位) |
| 59 | Capacitor CBB65 | 电容 | 压缩机 |
| 58 | Electric Box Assy | 电器盒部件 | |
| 57 | Thermal baffle | 隔热板 | |
| 56 | Foam (water tray) | 泡沫(接水盘) | |
| 55 | Chassis Sub-assy | 底盘组件 | |
| 54 | Power Cord | 电源线 | |
| 53 | Drainage Valve | 排水阀 | |
| 52 | Inhalation Tube 1 | 吸气管1 | |
| 51 | Overload Protector | 压缩机过载 | |
| 50 | Discharge Tube 1 | 排气管1 | |
| 49 | Compressor and fittings | 压缩机及其配件 | |
| 48 | Fan Motor | 电机 | 外右 |
| 47 | Outer support sub-assy (right) | 外支架组件 | |
| 46 | Capillary Sub-assy | 毛细管组件 | |
| 45 | Mid-Clapboard | 中隔板 | |
| 44 | Right side board of duct | 风道右边板 | |
| 43 | Motor Support Sub-Assy | 电机支架组件 | 内 |

材料:

商品型号: GAB7AB-D3RNB2A

图样标识: 重量比例

1:15 物料编码: GAB07ABD3RNB2A.BZ000000

共张第张

审核: 郭素 (00.00) 数据审核

会签: 批准

A

B